



Technical file- lynes

Design Checklist

CHECKLIST

- ☐ **USAGE** – wall or ceiling installation
- ☐ **SURFACE** - is a flat surface being used? Best results will show on a black background.
- ☐ **TECHNICAL DRAWING** - has the project completely been worked out with a drawing? Count in the corners, connections, integrated doors,...
- ☐ **PROFILE DIMENSIONS** – length of the profiles is 2700mm. For larger dimensions of the wall or ceiling: use connection clips and/or waste material. A profile should be sustained by at least 2 clips.
- ☐ **WEIGHT** - is the surface strong enough to hold the construction? Especially important for ceiling installation. (see data sheets for weight).
- ☐ **APPROVAL** – Has the design been approved by the designer or architect?
- ☐ **EXPANSION** – Please count in possible expansion of (especially) the MDF profiles
- ☐ Are there any (light) switches or other extra's which need to be considered?
- ☐ **ELECTRICITY** – Provide the necessary space for transfo's, which are needed for the LED strips. Electricity applications need to be accorded with the architect or electrician.

The parts

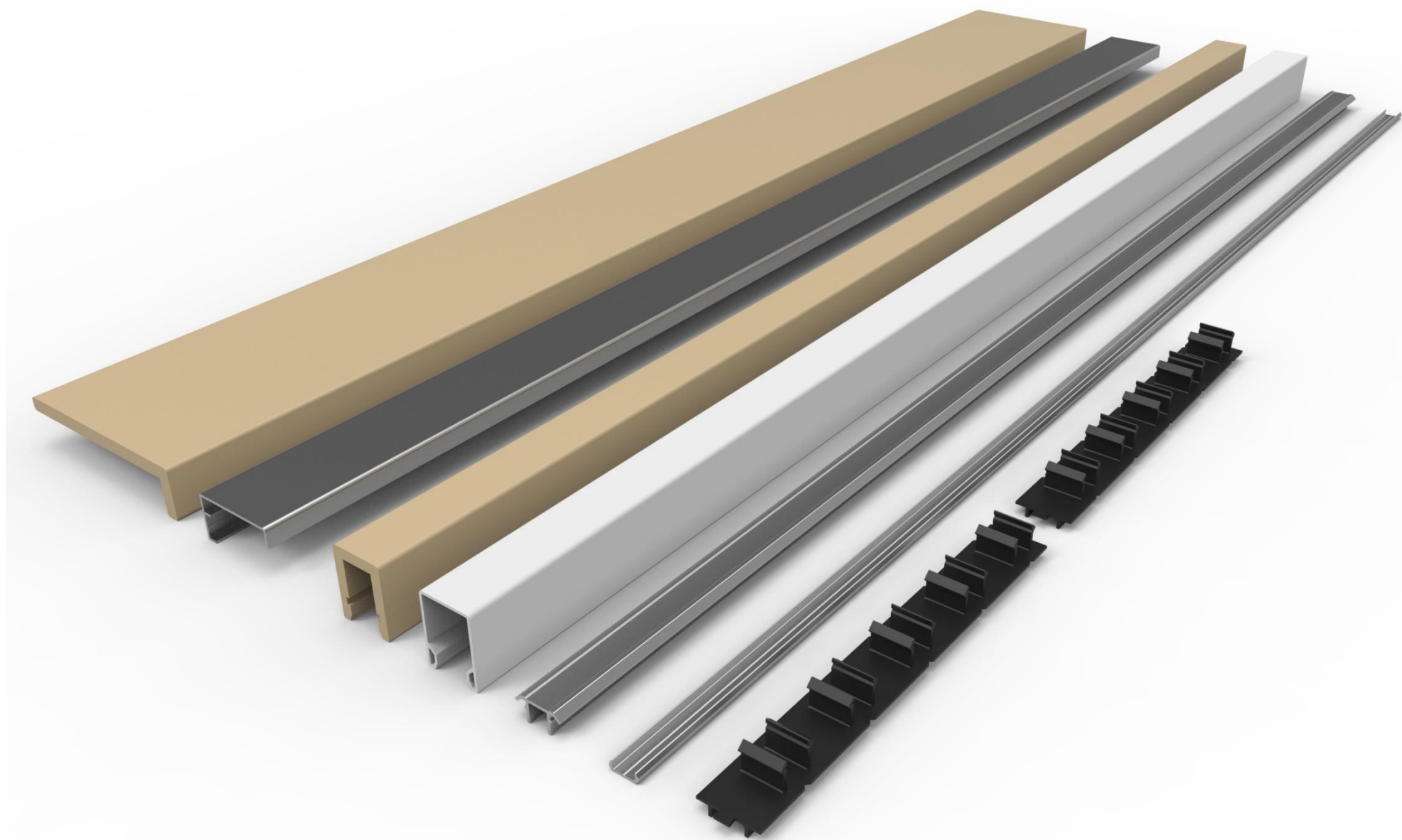

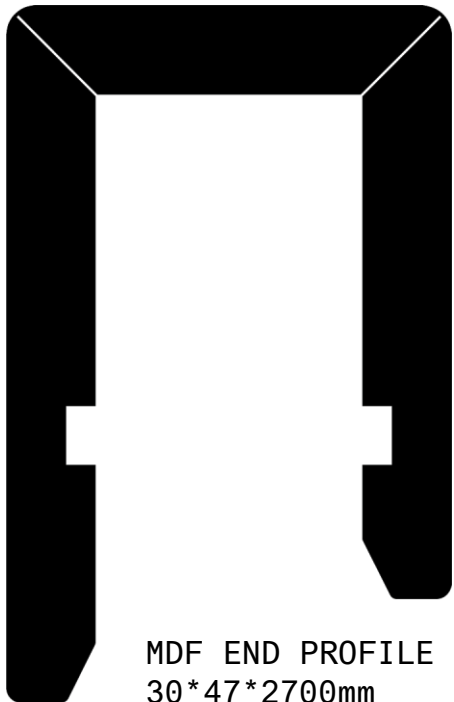

MDF END PROFILE
30*47*2700mm

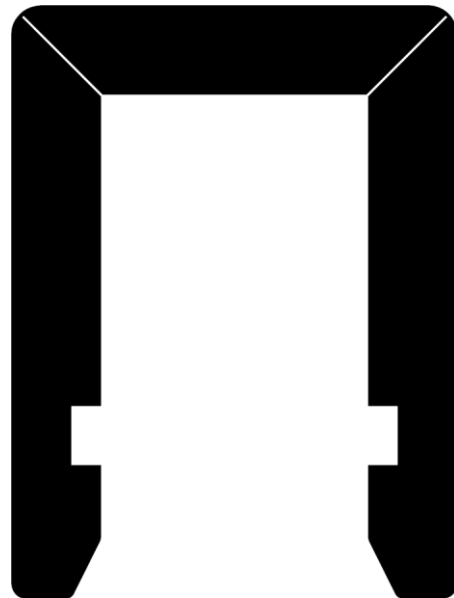

MDF BASE PROFILE
30*40*2700mm

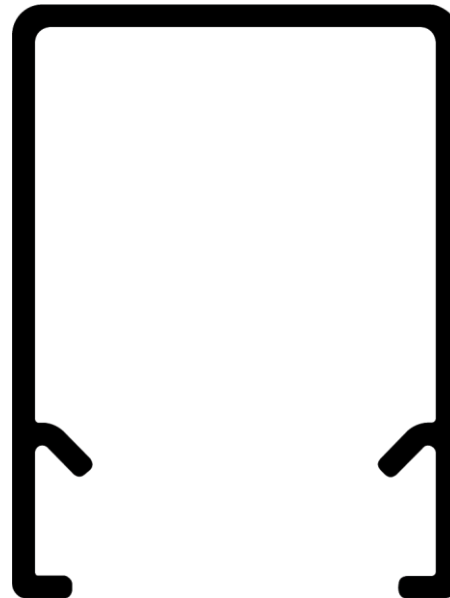

LIGHTING PROFILE
30*40*2700mm

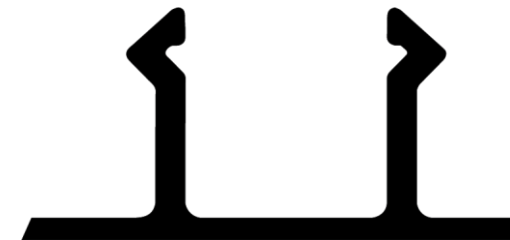

MOUNTING CLIPS
20*30*230mm

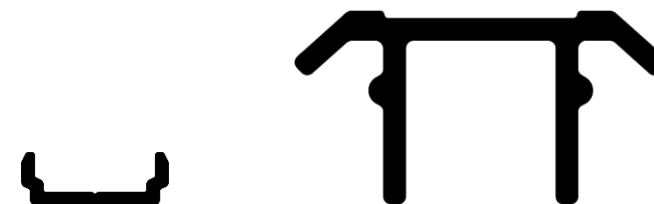

ALU LED PROFILE
25*13*2700mm

ALU MOUNTING RAIL
15*5*2700mm

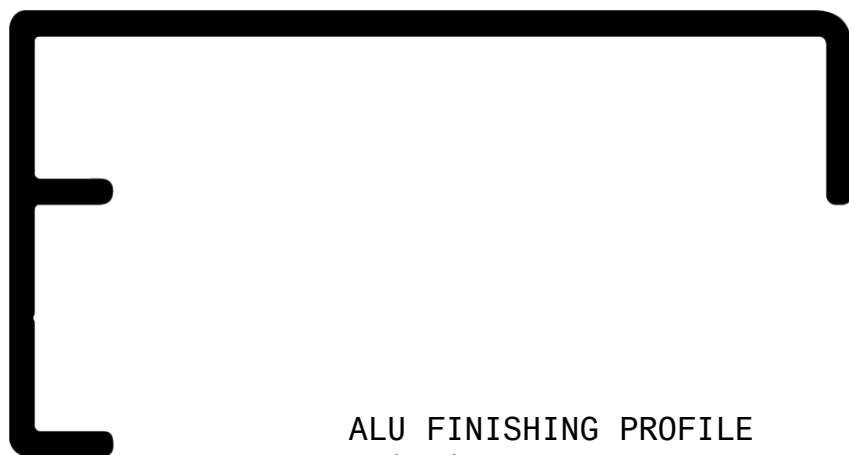

ALU FINISHING PROFILE
50*26*2700mm



MDF FINISHING PROFILE
120*30*2700mm

CAD-drawing will be available for download on the website soon.

We cannot emphasize enough that it is important to plan the project completely with a drawing, to guarantee a perfect installation. You can always contact us for more information.

Installation steps

1

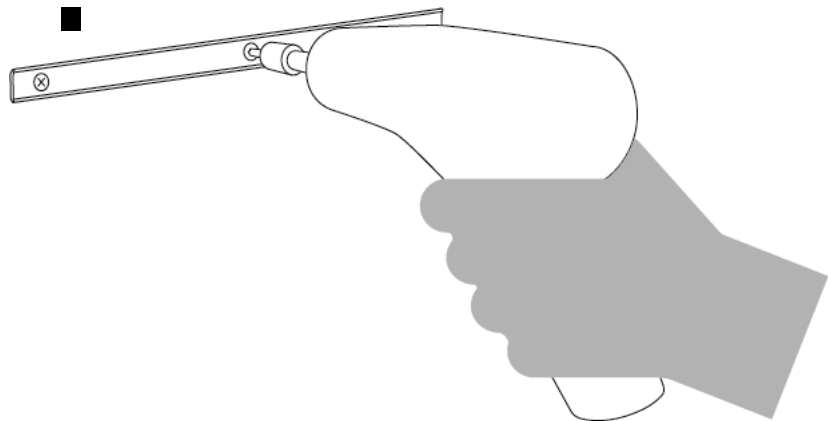

2

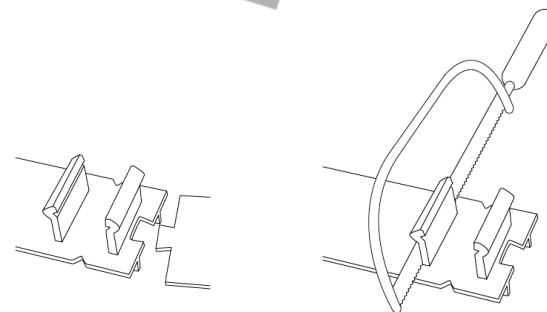
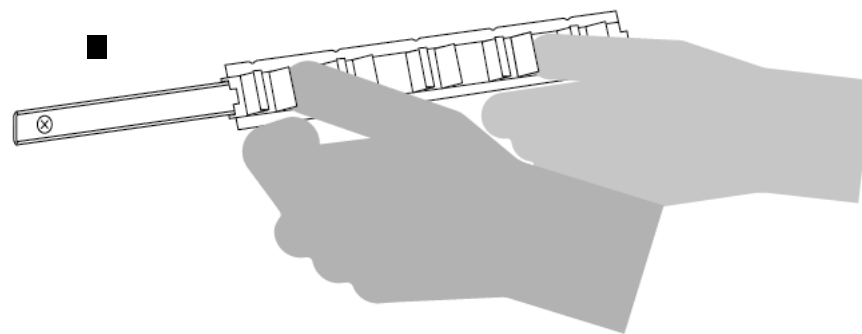

3

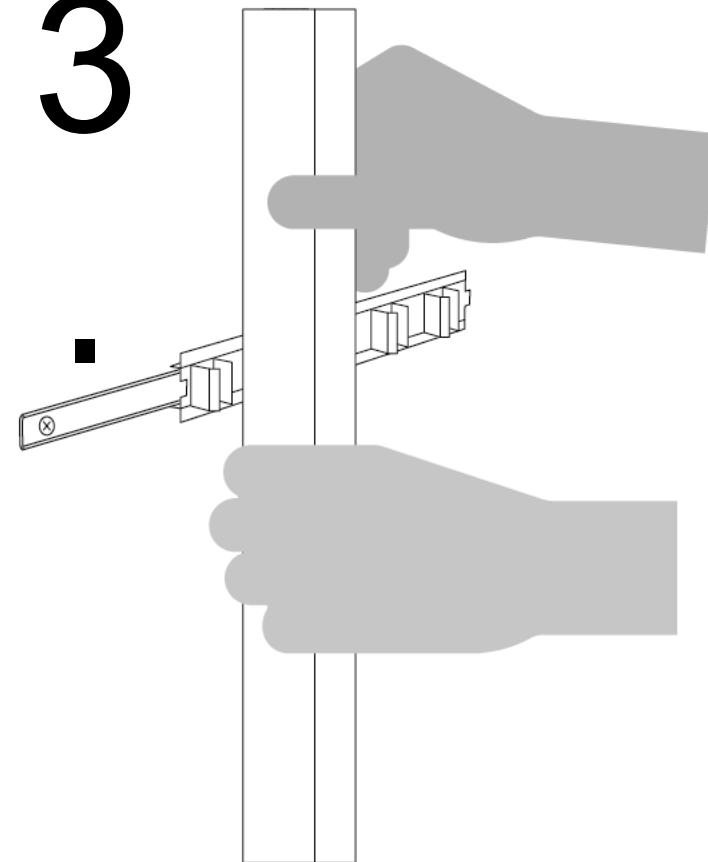

BEST RESULT = BLACK BACKGROUND / BASE LAYER

Installation LED

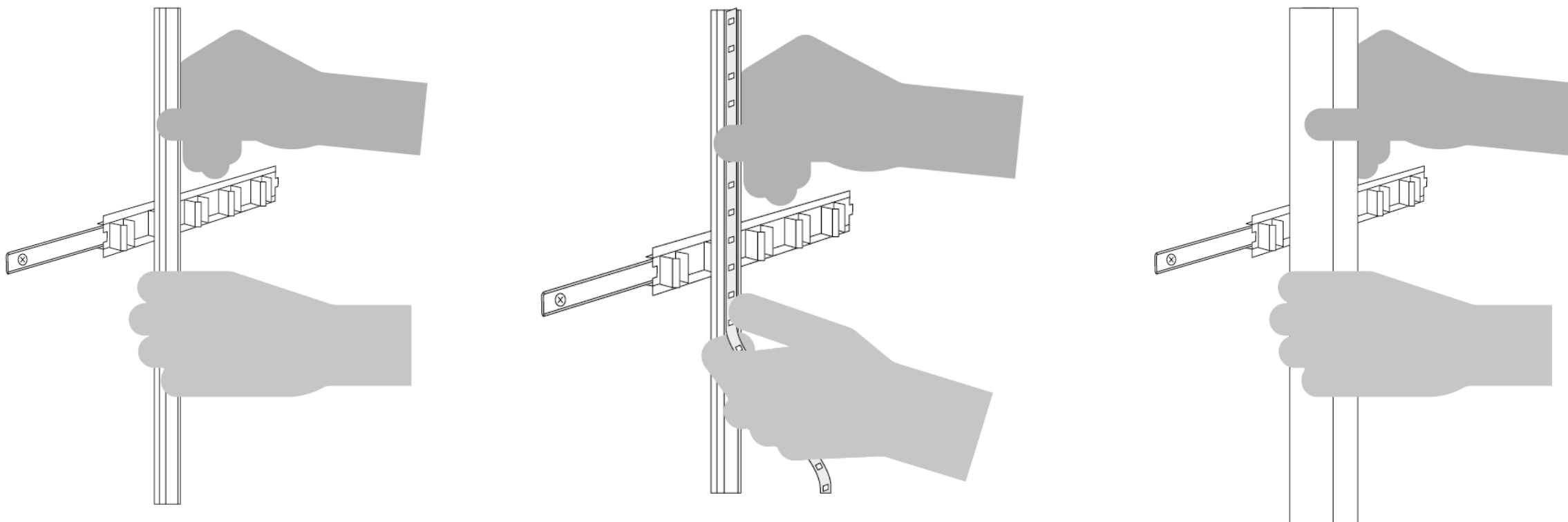

Led strips : provided by customer / electrician

→ Recommended: LED temperature : 4000K , light strength minimum 1200 lm/m

Spacing mounting profiles

→ 1 profile per 0,5 meter

→ Minimum 3 profiles

Fixing mounting profiles

→ With screws, each 30 cm

→ Mounting rails are not pre-drilled !

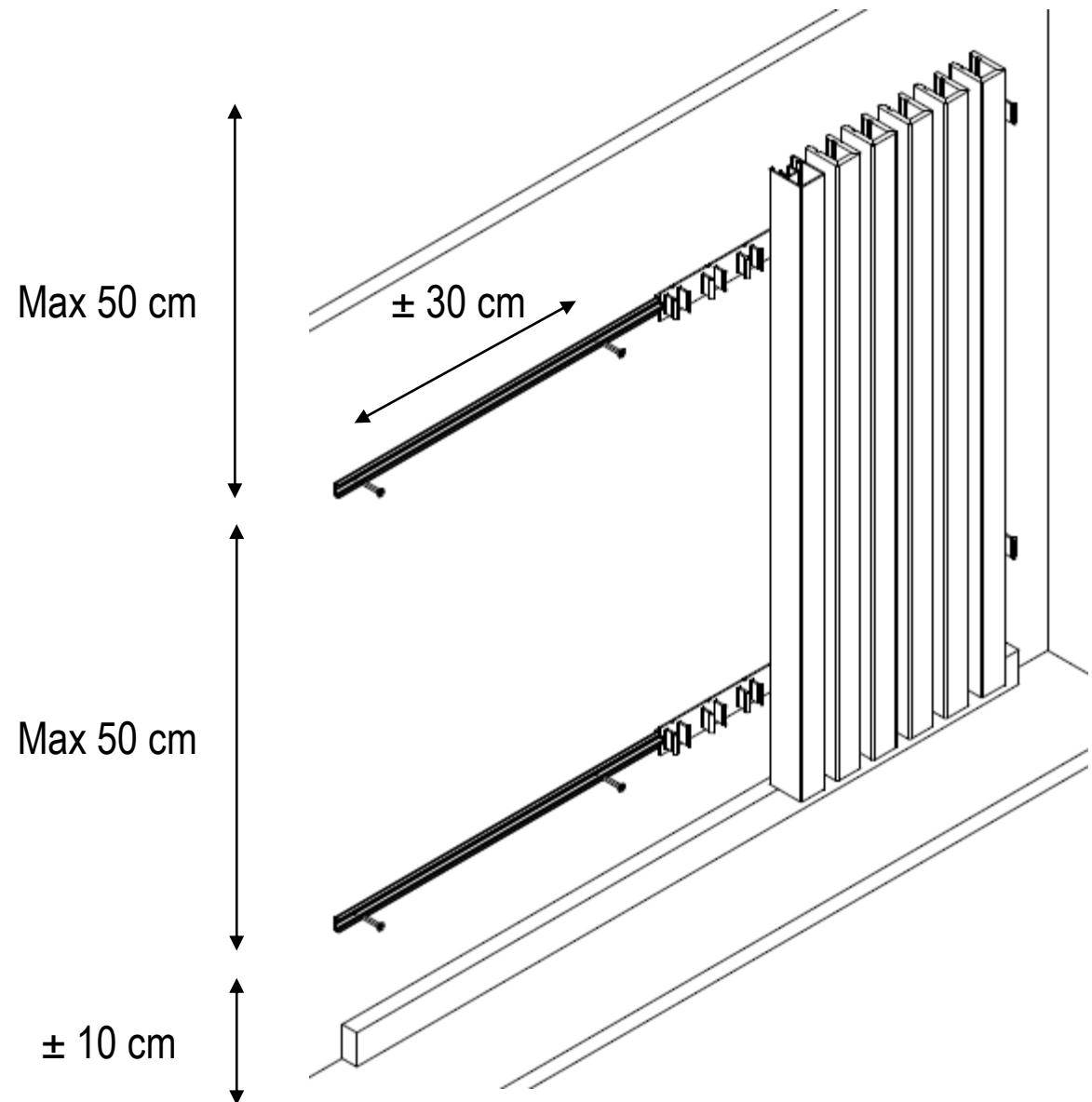

Technical information

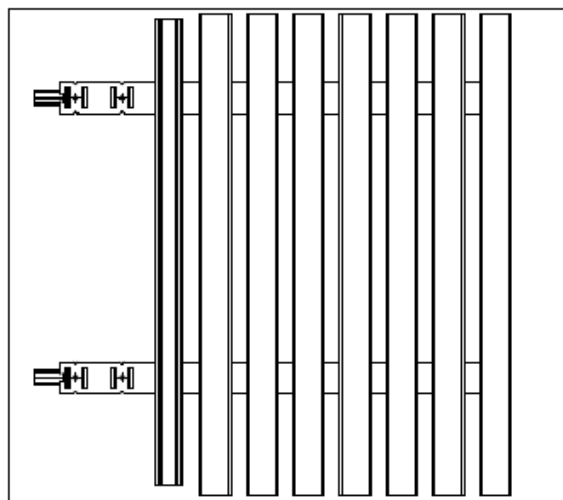

Front1



Left1

Mounting profile

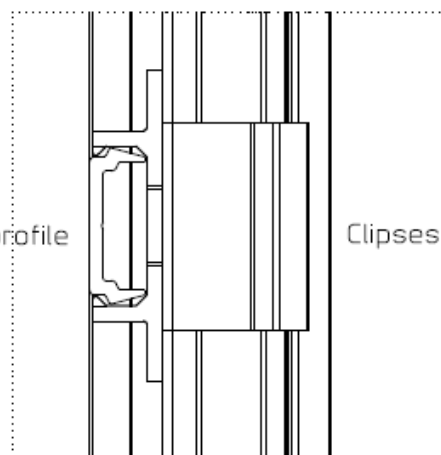

Clipses

Detail4
SCALE 2:1

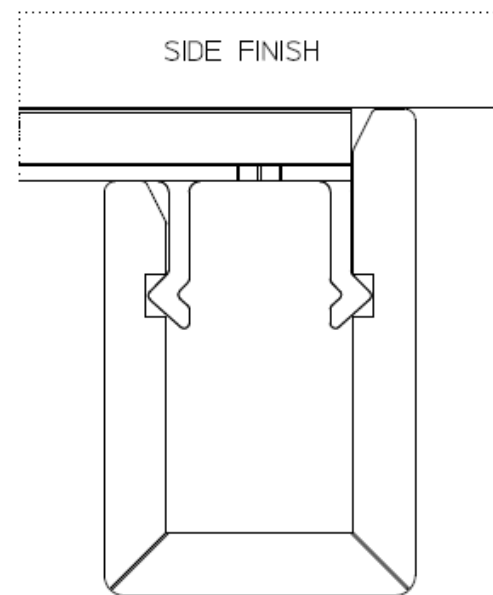
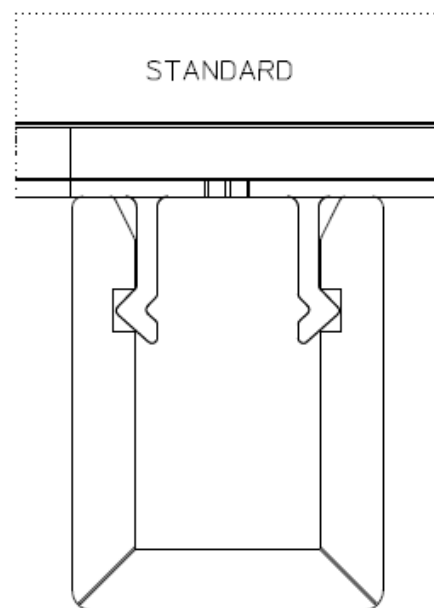
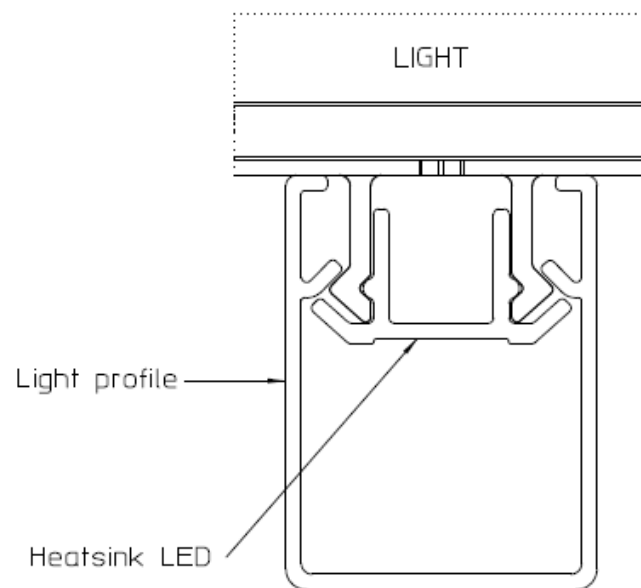
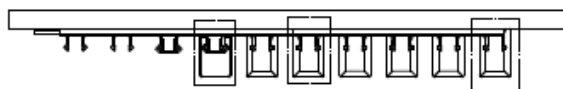

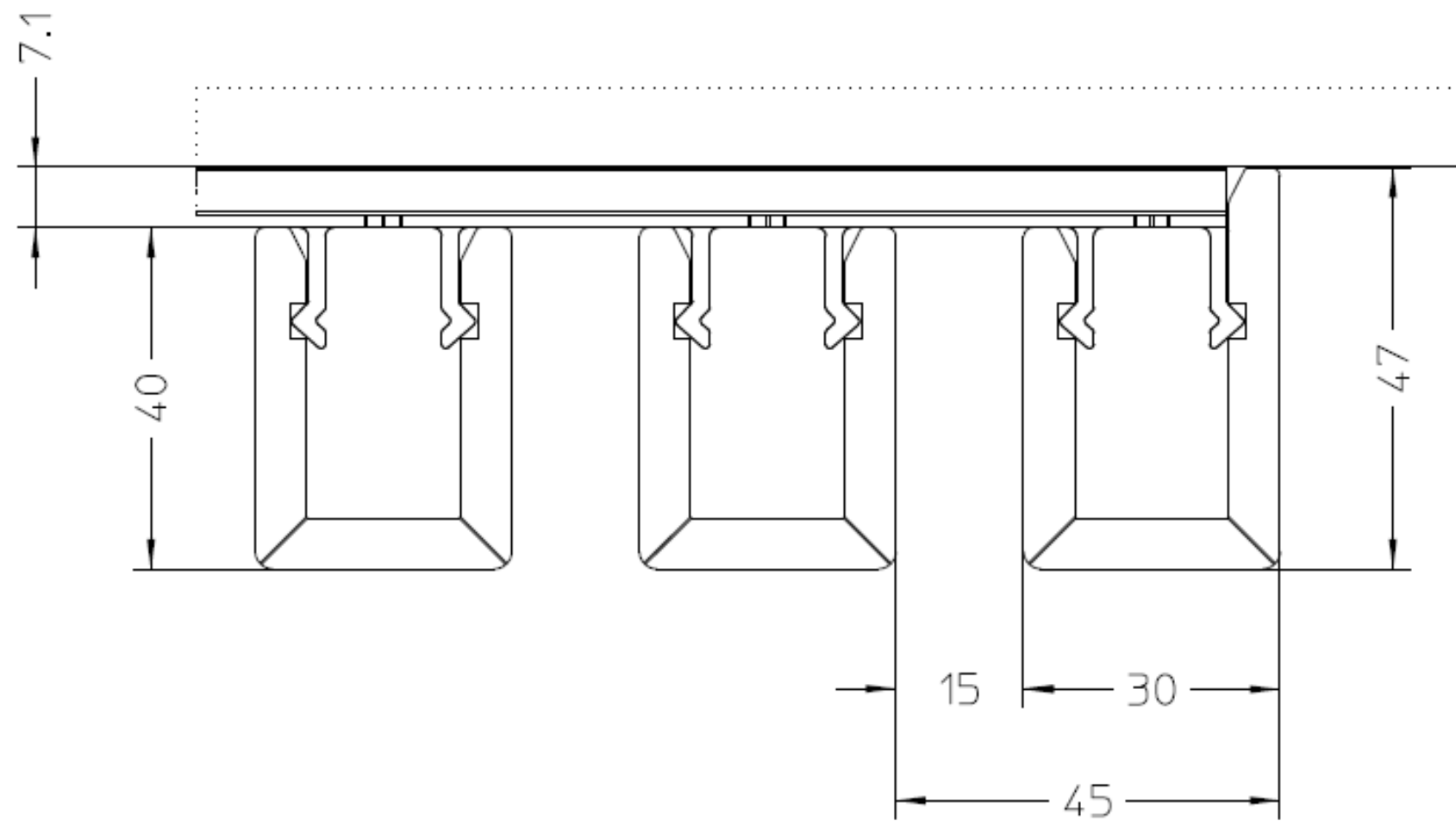

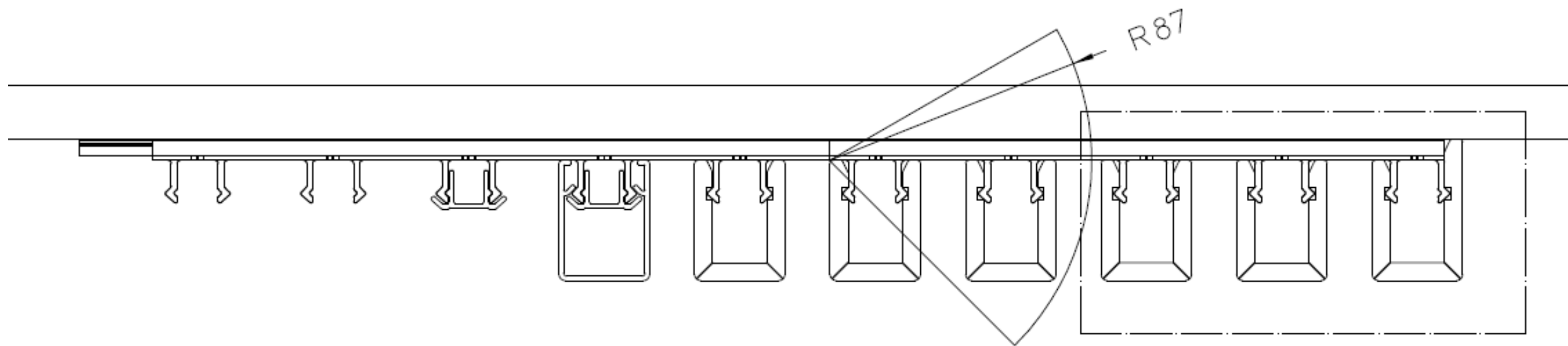

Finishing BELOW

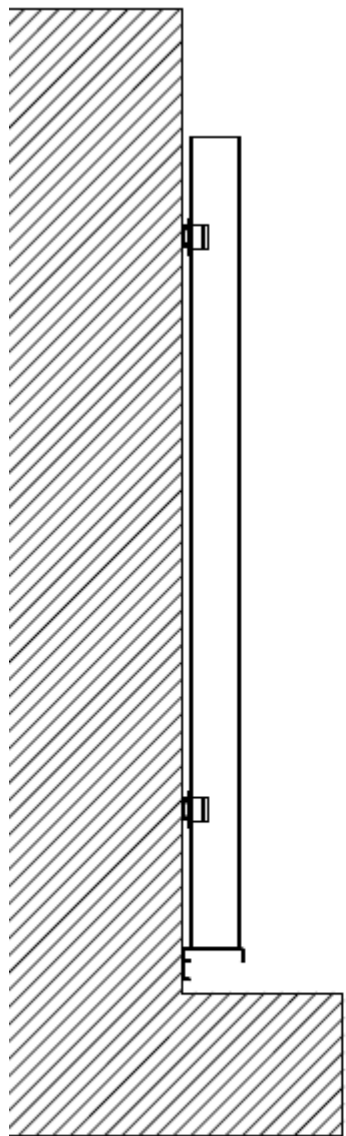

ALU FINISHING PROFILE

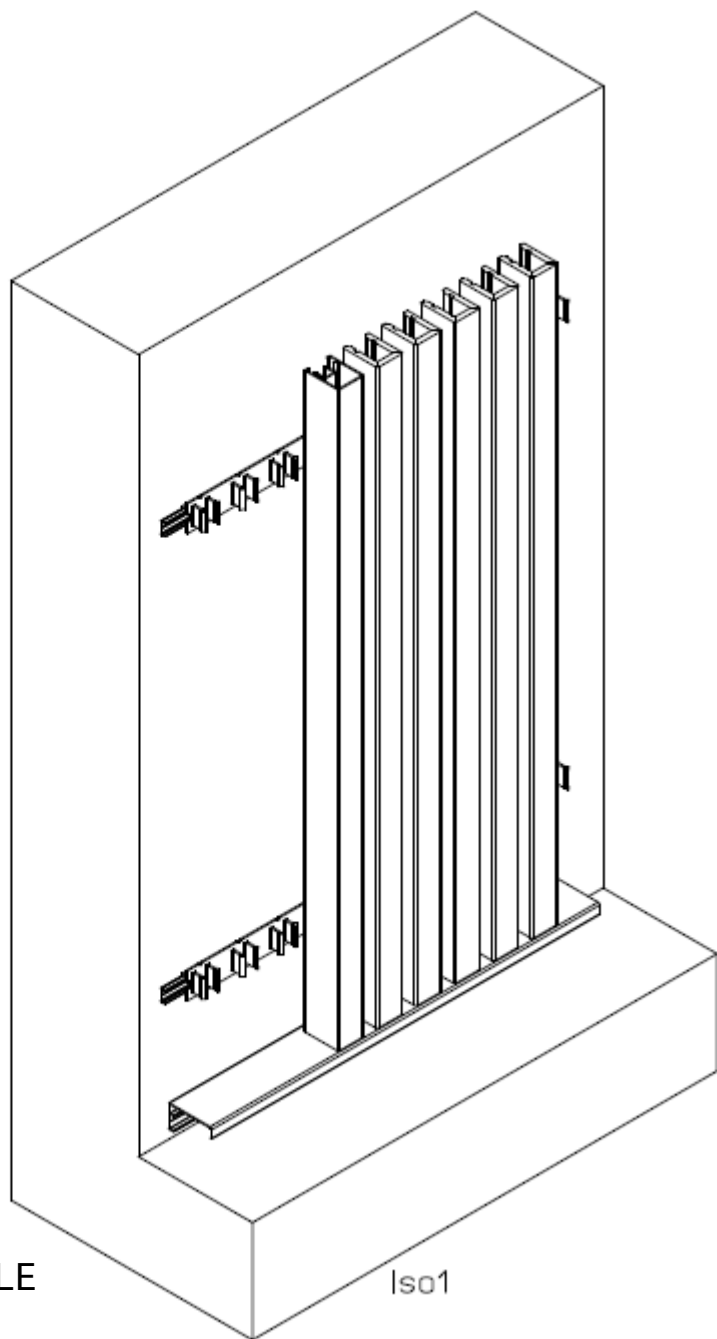

Iso1

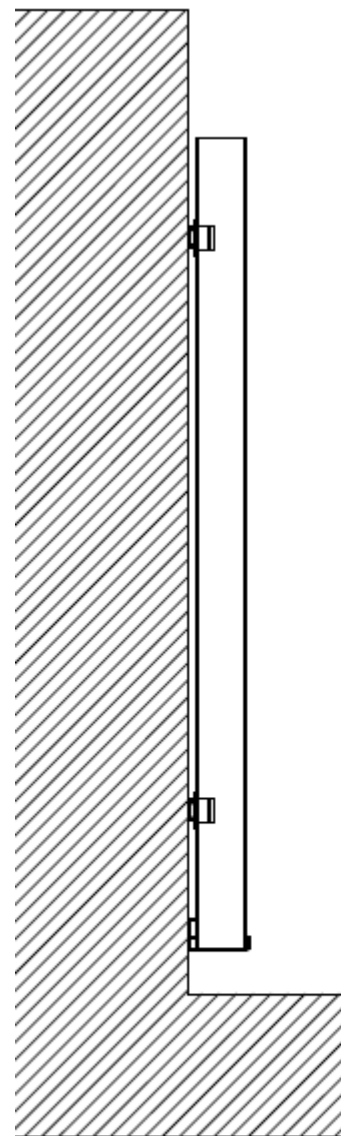

ALU FINISHING PROFILE

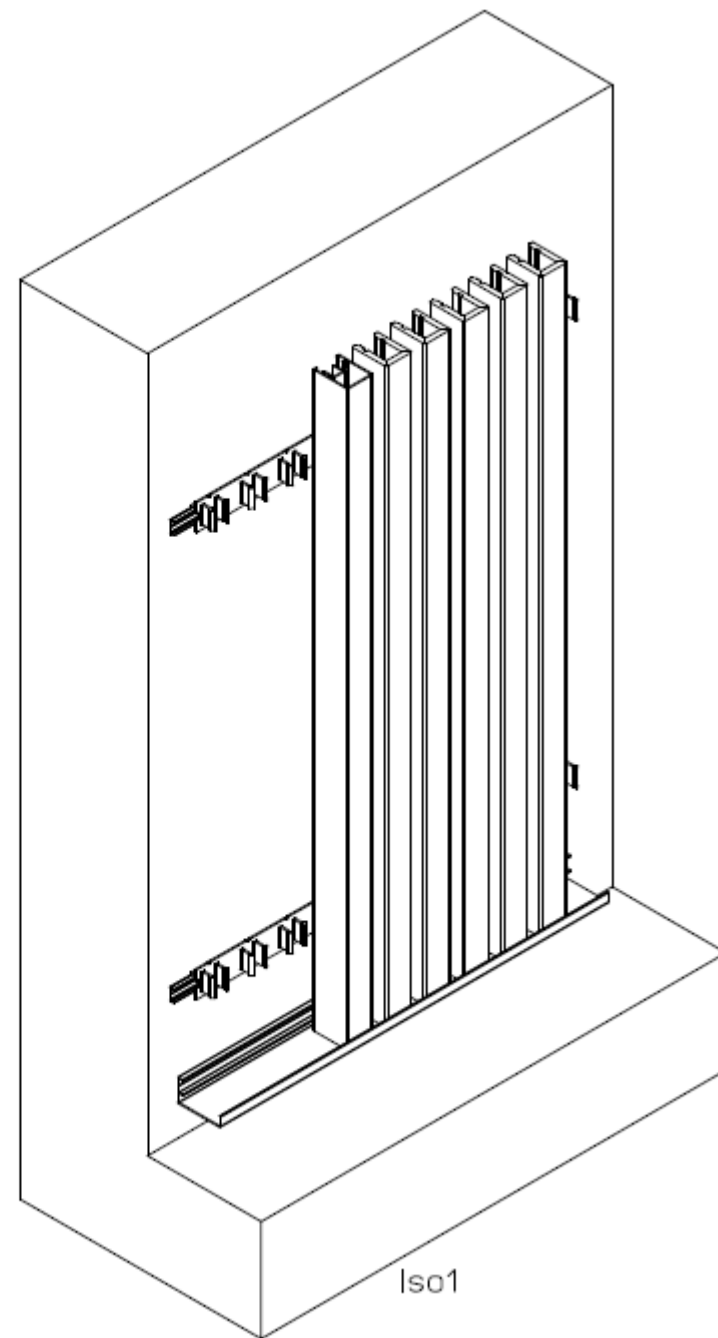

Iso1

Finishing ABOVE

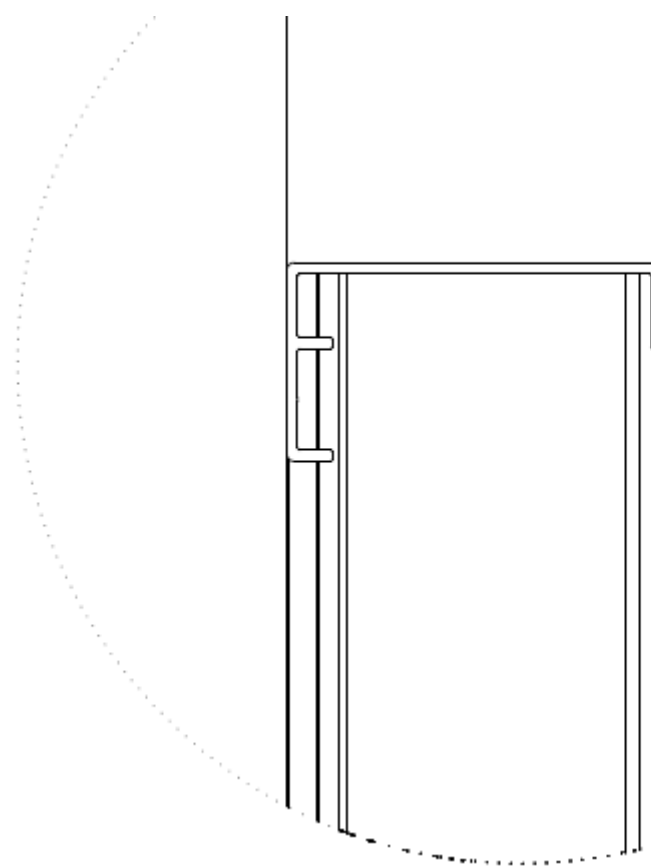
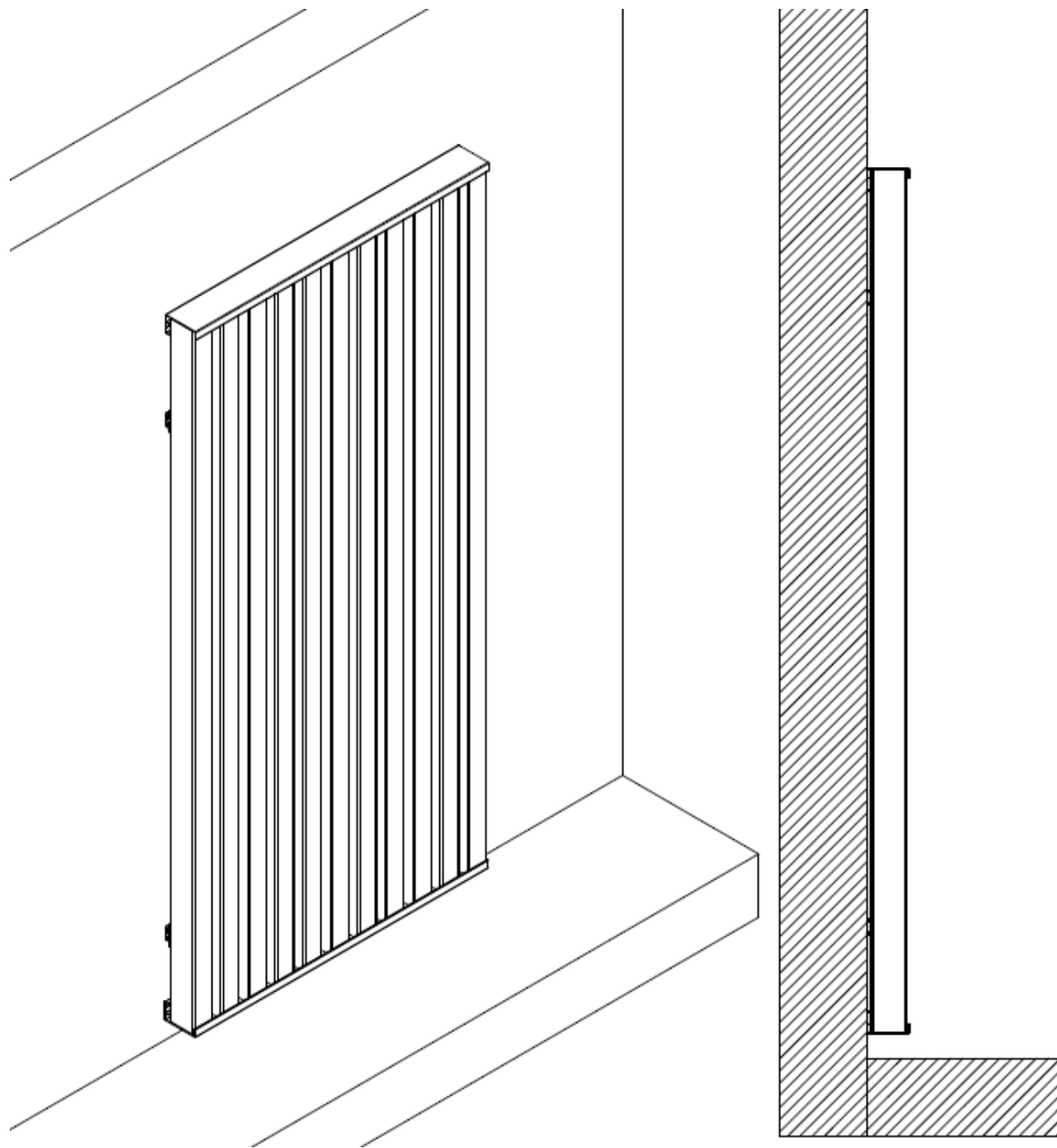

ALU FINISHING PROFILE

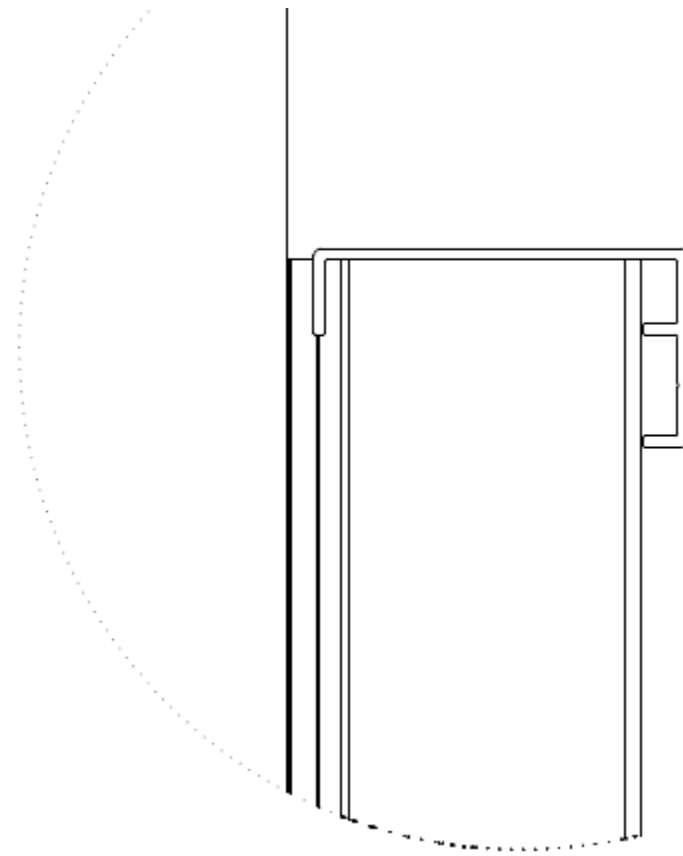
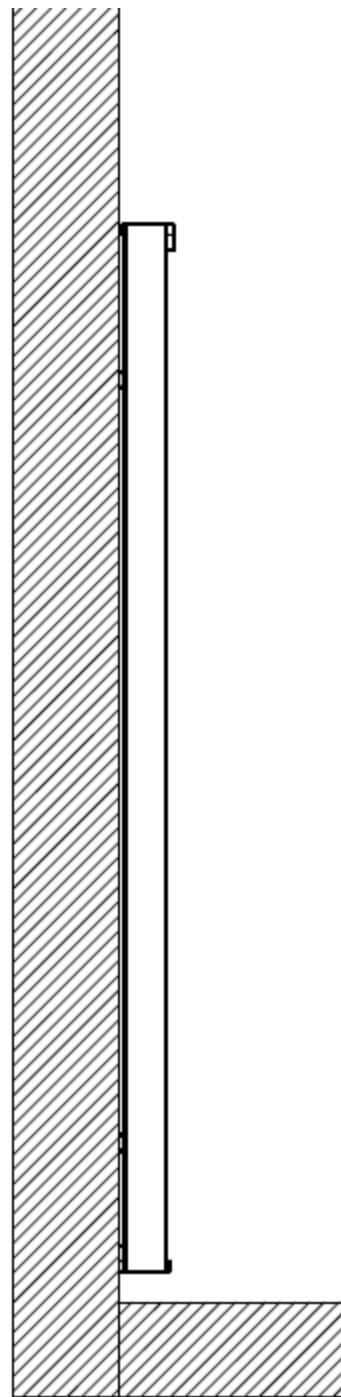
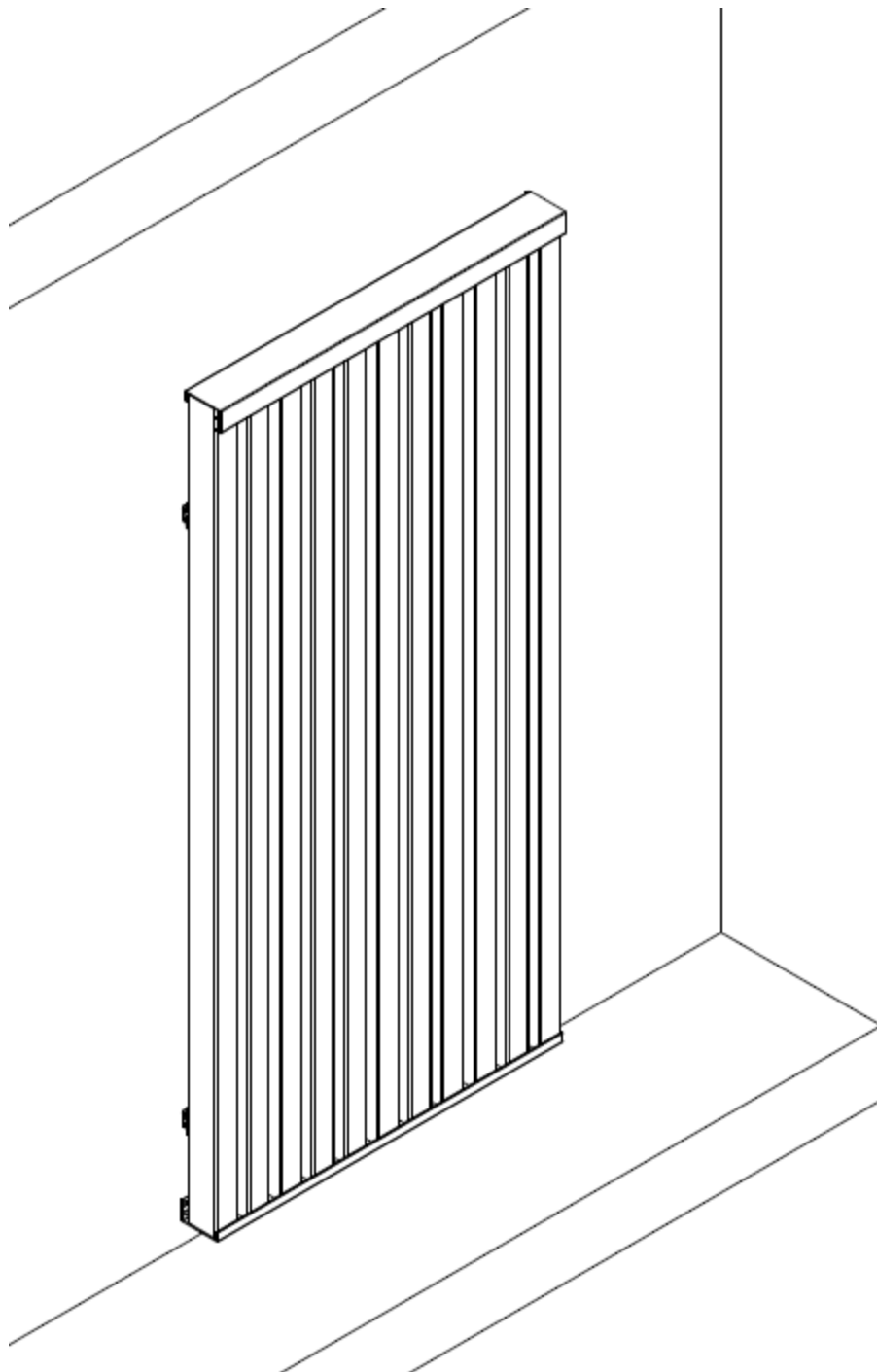

ALU FINISHING PROFILE

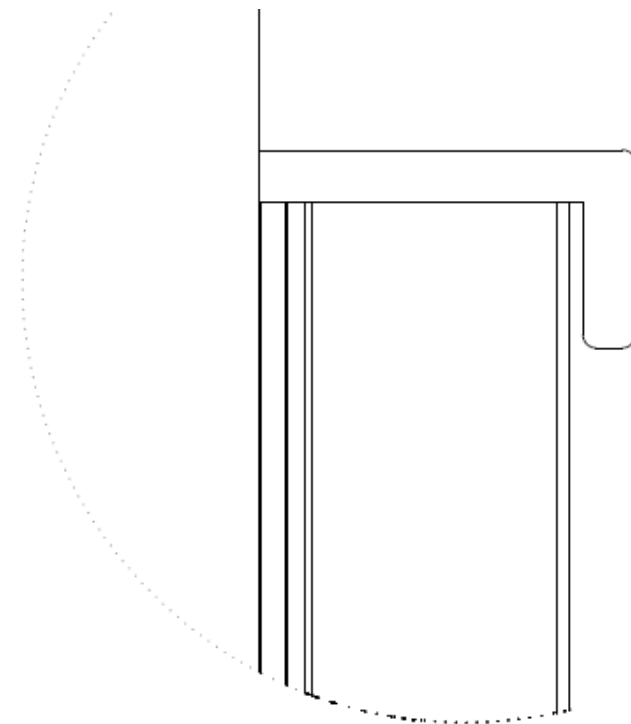
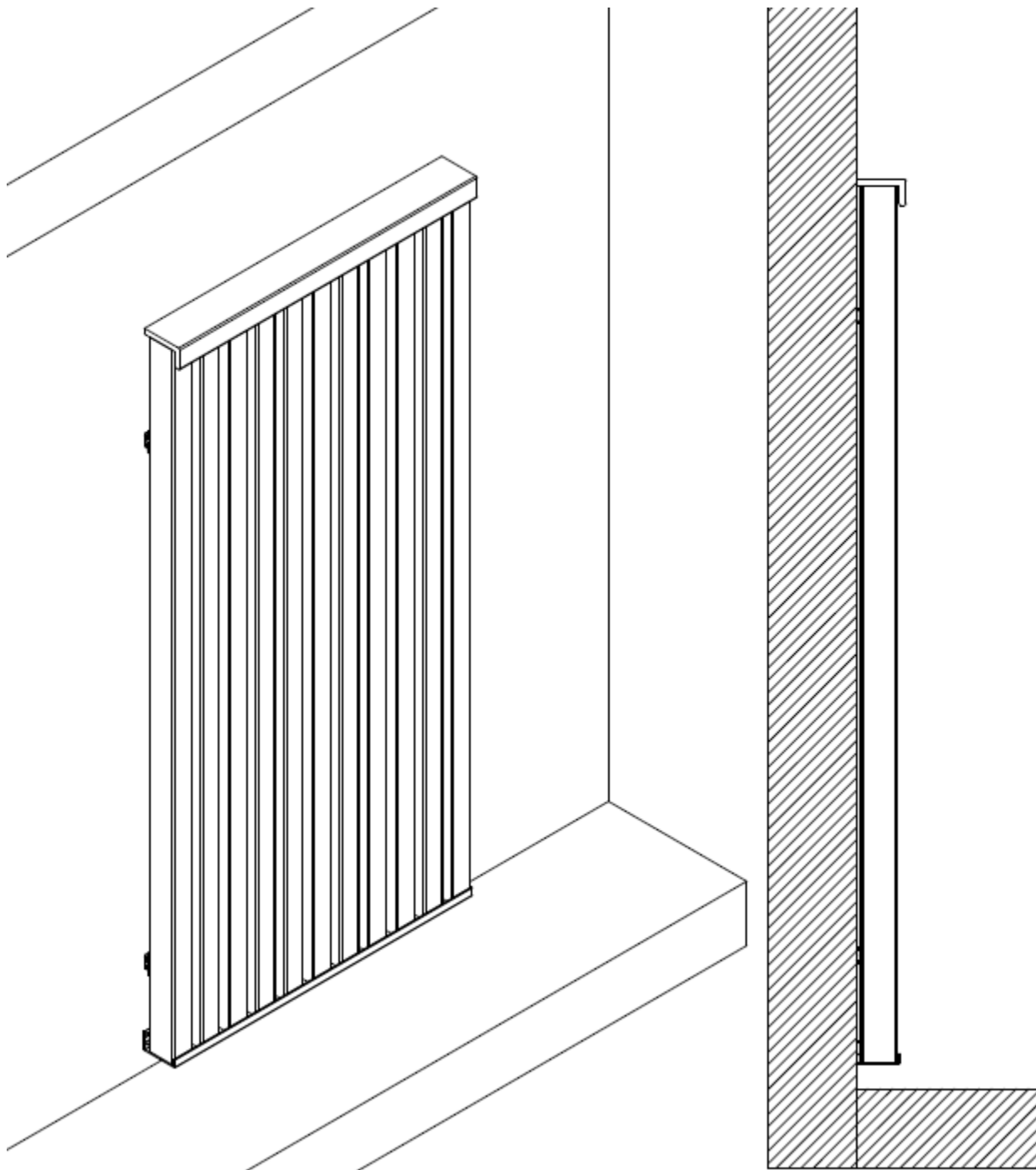

Shorten to desired dimensions

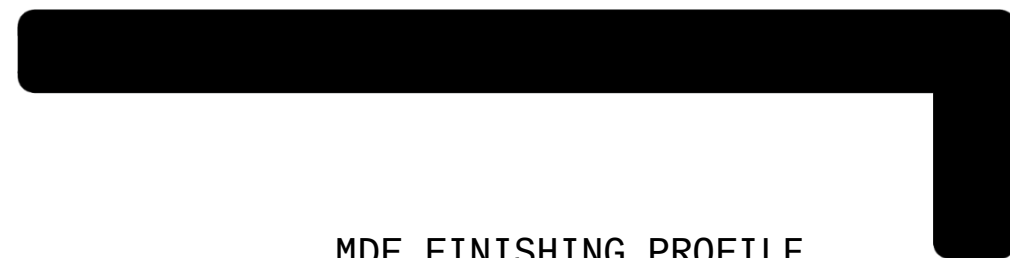

MDF FINISHING PROFILE

SIDE COVER

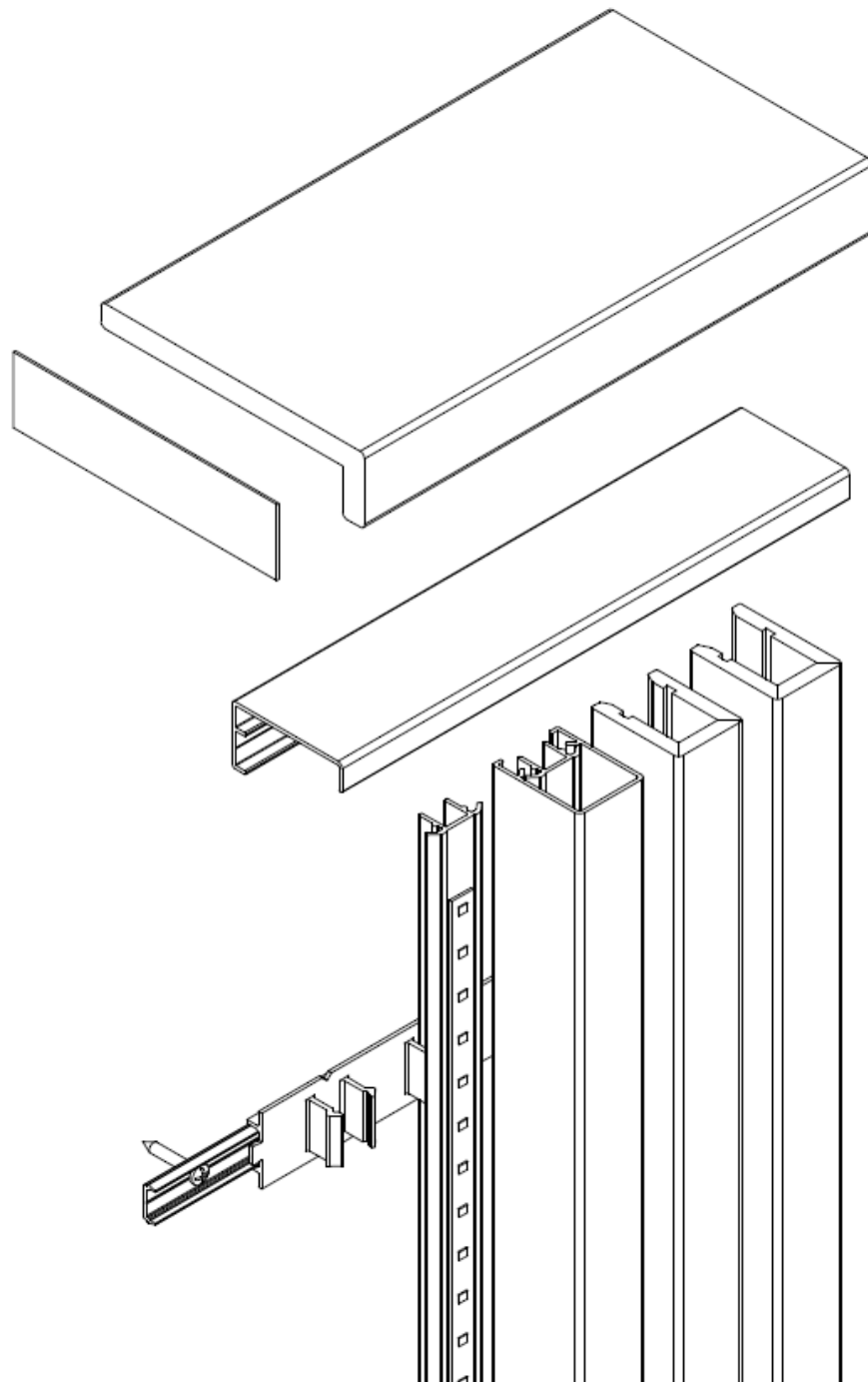

MDF FINISHING PROFILE

ALU FINISHING PROFILE

EXTRA

CONNECTION CLIPS
To connect MDF profiles

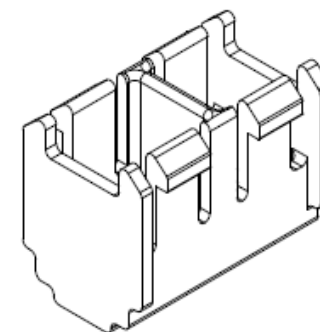
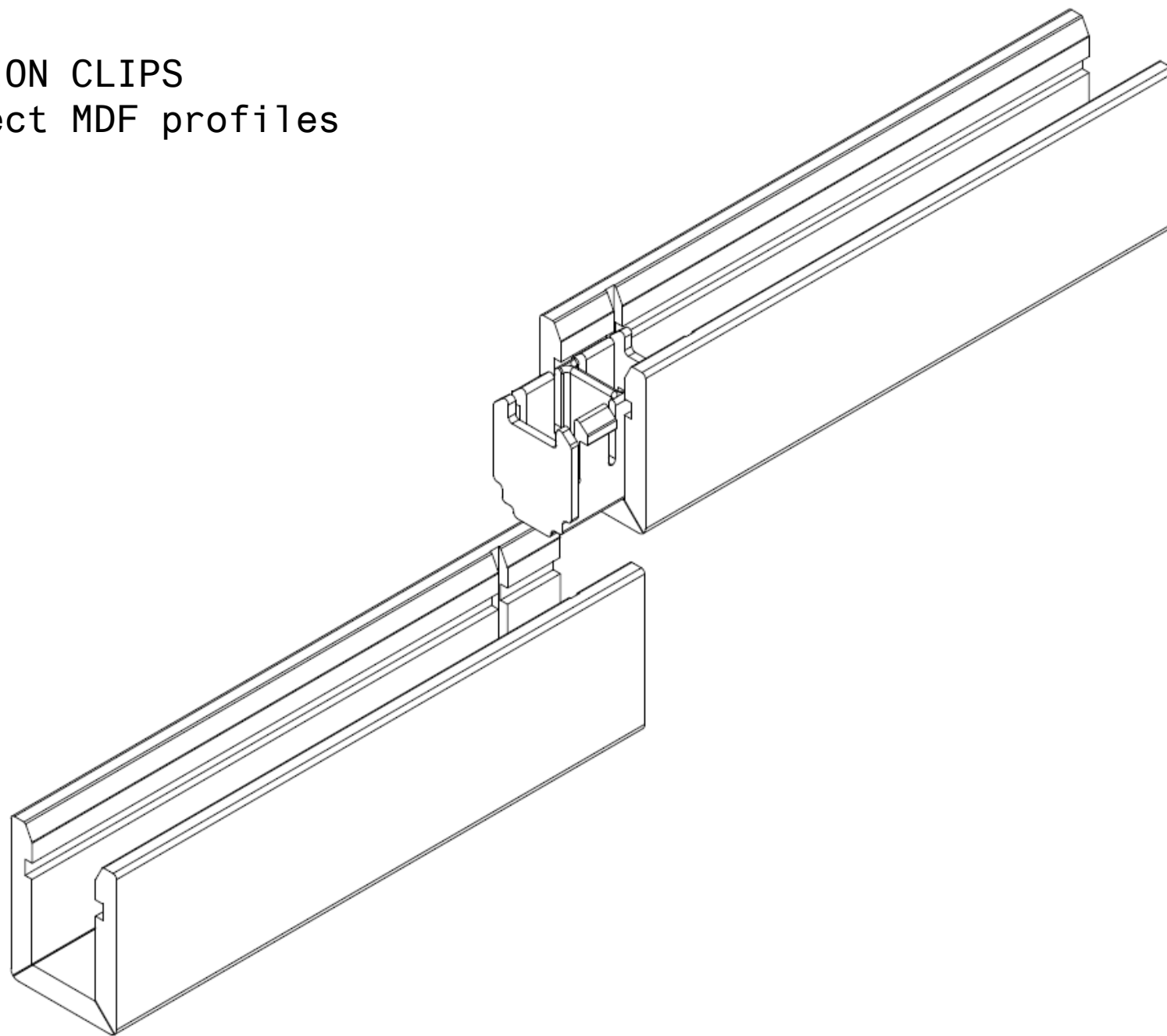

Packaging

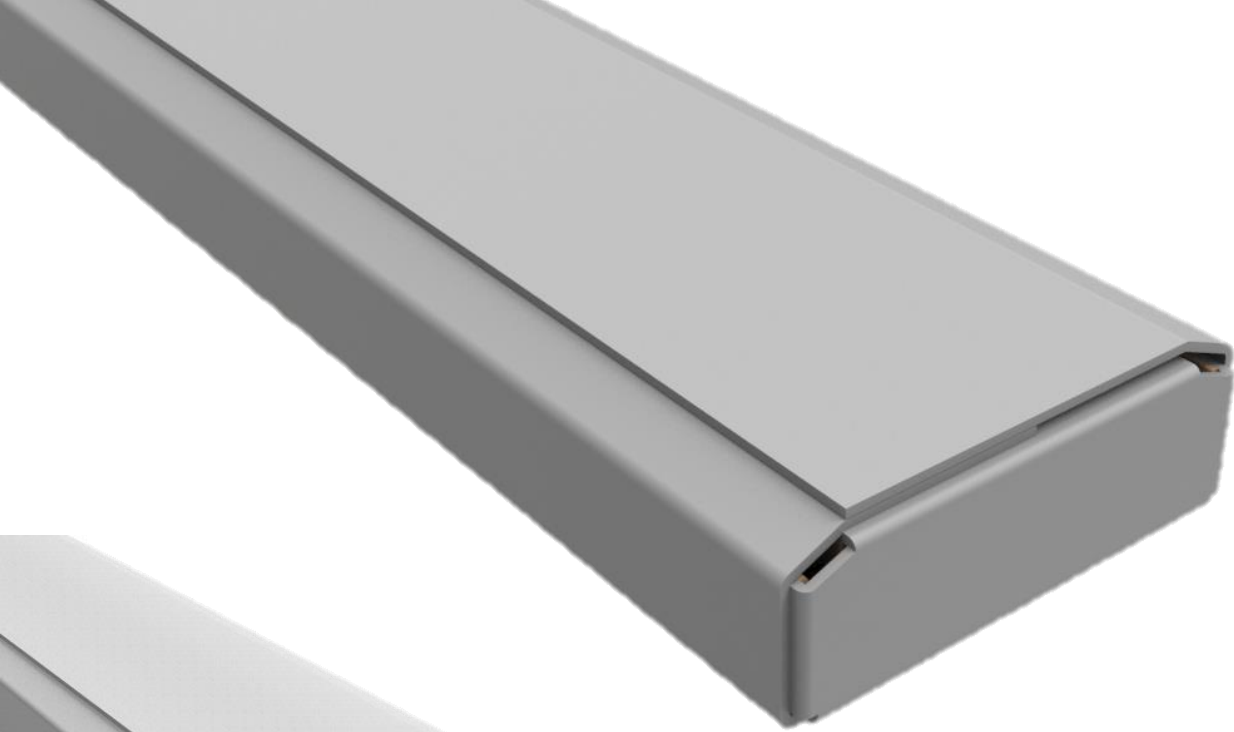

BASE PROFILE
9 pieces in cardboard box
Length profiles = 2,7m



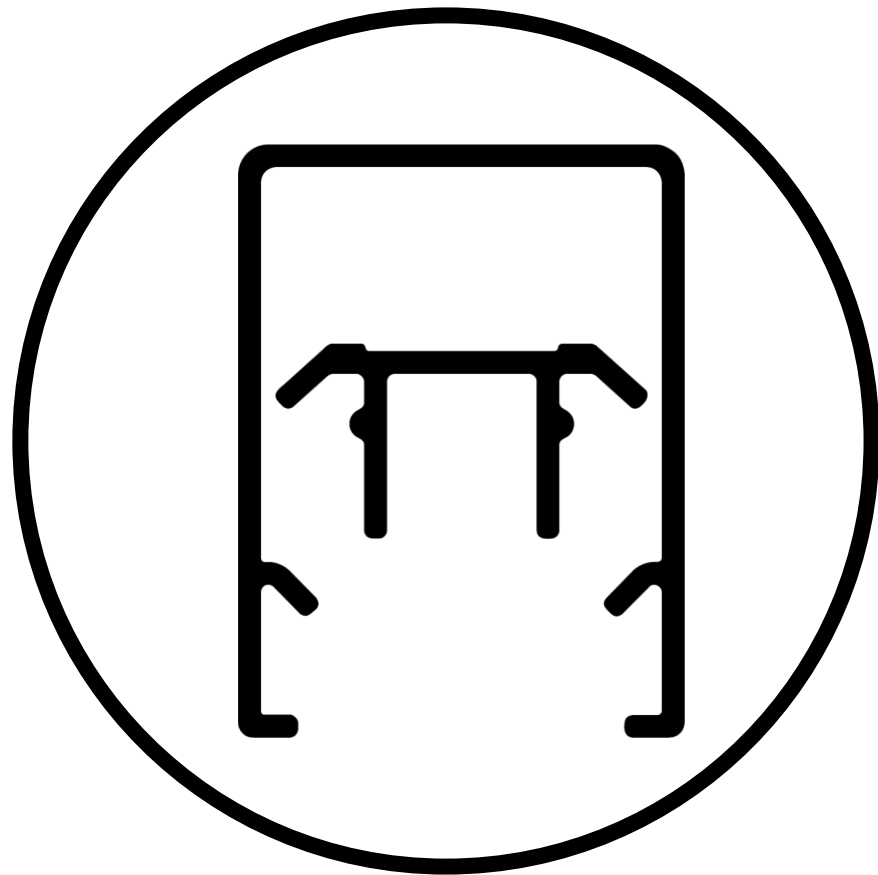

LIGHTING PROFILE + ALU LED PROFILE
Together in a cylinder with outer
diameter 53mm
Length profiles = 2,7m

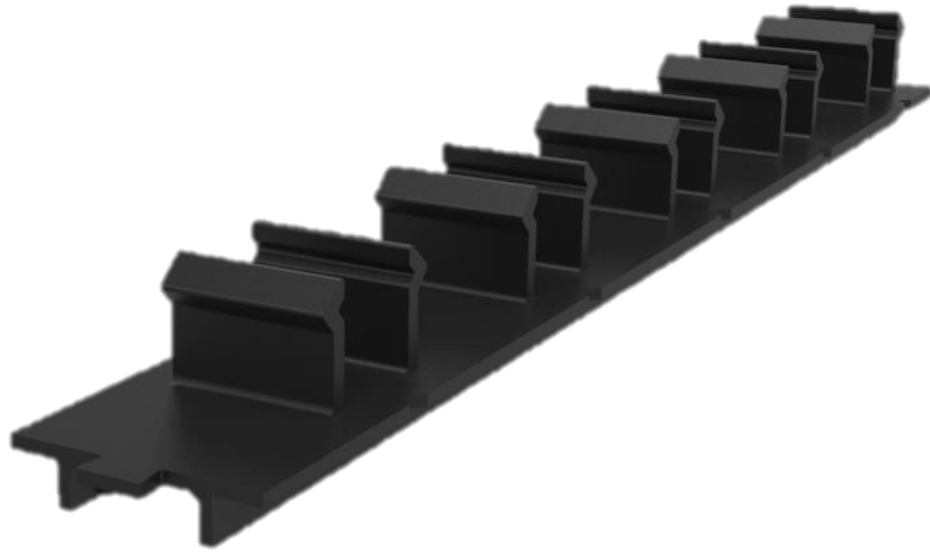

MOUNTING CLIPS

30 pieces per box (250*150*100mm)

5 clips per 1m alu attachment rail

± 15 clips /m²

On average 1 box per linear meter
for a standard room height. (\pm
2,5m)

ALU MOUNTING RAIL

per piece in shrinking foil, length 2700 mm



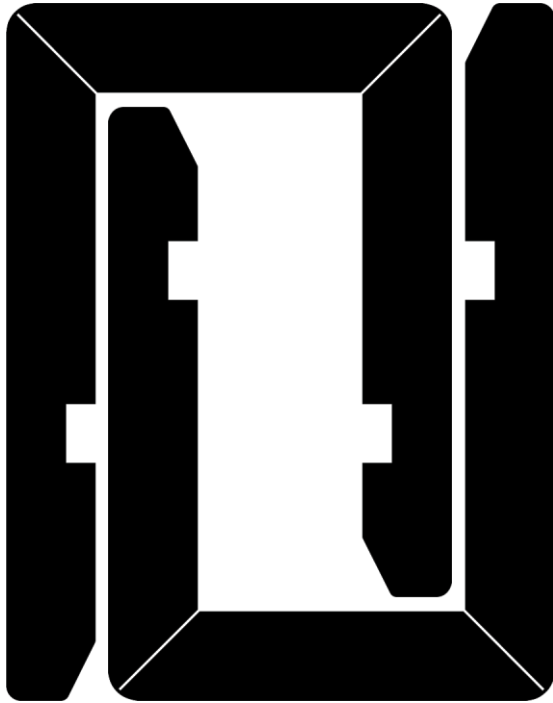

END PROFILES

2 pieces in cardboard box

Length profiles = 2,7m

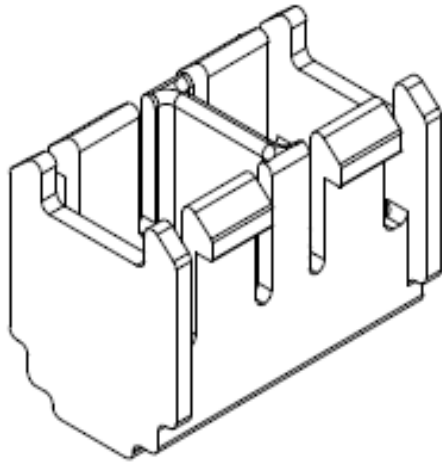

CONNECTION CLIP

10 pieces per box (120*70*40 mm)

6 boxes in outer box (250*150*100mm)